

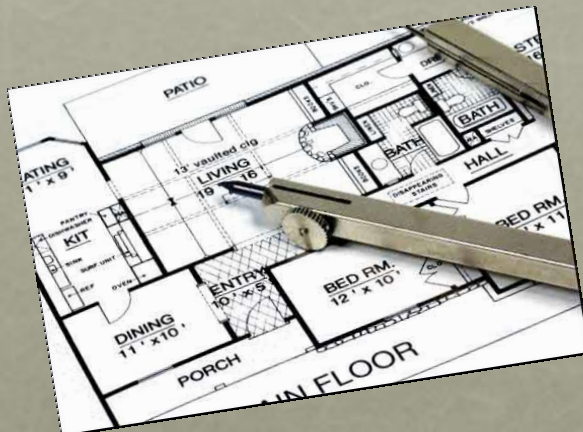

PRACTICAL ARTS

BUSINESS & TECHNOLOGY
EDUCATION
COURSE OPTIONS



The State Graduation Requirement

• *Five Credits*

WHAT ARE YOUR INTERESTS?

- EXPLORE
 - Take a variety of different courses
- FOCUS
 - Take multiple classes in one area
- CONCENTRATE
 - Take a sequence of courses and additional electives toward a post high school program

THE BUSINESS DEPARTMENT... IT'S NOT ALL BASIC!

Introduction to Word Processing

Internet & Web Design

Word Processing



Introduction to Law

Law Seminar

Consumer Education

A screenshot of the X-Arcade website homepage. The header features the X-Arcade logo and navigation links: HOME, X-ARCADE PRODUCTS, YOUR ULTIMATE GAMEROOM, EXCUSES TO BUY, 411, and NEWSLETTER. The main content area includes a large banner for 'RELIVE Thousands OF ARCADE CLASSICS!' featuring a 'BUILD MY X-ARCADE' button and a 'GREAT FINANCE' badge. Below this is a section titled 'The Ultimate Game Room Experience' with a sub-header 'Well let's put it this way, some scientist friends of ours predict that when the world ends there will be two things that will survive, cockroaches and Your X-Arcade™ Gear.' and a sub-header 'Now having your game roots gear survive the apocalypse may not be all that useful, as you probably won't be around to enjoy it, but it does give you an idea of what kind of punishment it can withstand.' The bottom of the page features a 'Two Much!' banner with 'SPUDLET', 'DEFENDER', and 'SMASH' logos, and a 'PC' banner with the text 'YOU HAVE TO SEE IT to Believe It!' and 'x2'.

PERSONAL FINANCIAL LITERACY

- Required Course
 - *2.5 Credits (Semester)*
 - *N.J.A.C. 6A:8-5.1(a)1v*
- Financial Management
- Consumer-Purchasing Strategies
- Banking



OPTIONS FOR A FOCUS IN BUSINESS

Computer Applications

Accounting



Publications I & II (Yearbook)

Marketing

TECHNOLOGY EDUCATION FOUNDATION COURSES

Mechanical Drawing

Inner Planet (4 OF)
Outer Planet 4
Outer Planet 1
Carrier
Sun
Outer Planet 2
Outer Planet 3
Ring

Outer Planets
Inner Planets
Ring Shaft
Sun Shaft
Ring
Carrier Shaft
Sun

Gear	Radius	SHAFTS ARE IN INCHES	NAME	DATE
Sun	r_s	TOLERANCES:	DESIGN	
Outer Planet	r_{po}	FEELERS:	CHECKED	
Inner Planet	r_{pi}	ANGULAR MATCH: 8800 ±	ENG APPR	
Carrier	r_c	TWO PLACE DECIMAL ±	MFG APPR	
Ring	r_r	THREE PLACE DECIMAL ±	D.A.	
		MATERIAL: ---	COMMENTS:	
		FINISH: ---		
APPLICATION	DO NOT SCALE DRAWING			

Copyright Prohibited:
THE INFORMATION CONTAINED IN THIS DRAWING IS THE SOLE PROPERTY OF The MathWorks Inc. ANY REPRODUCTION IN PART OR AS A WHOLE WITHOUT THE WRITTEN PERMISSION OF The MathWorks Inc. IS PROHIBITED.

The MathWorks Inc.
SimDriveline

A Dual-Ratio Planetary Gear
SCALE: 1:1 SHEET: 1 OF 1

Robotics I & II



TECHNOLOGY EDUCATION FOUNDATION COURSES

Introduction to
Woodworking



Woodworking
Process

“Technology: Design, Engineering and Innovation”

A CONCENTRATION IN TECHNOLOGY EDUCATION

- Adv. Architecture CAD I & II
- Adv. Machine CAD I & II
- Industrial Design
- Contemporary Woods
- Cabinetmaking

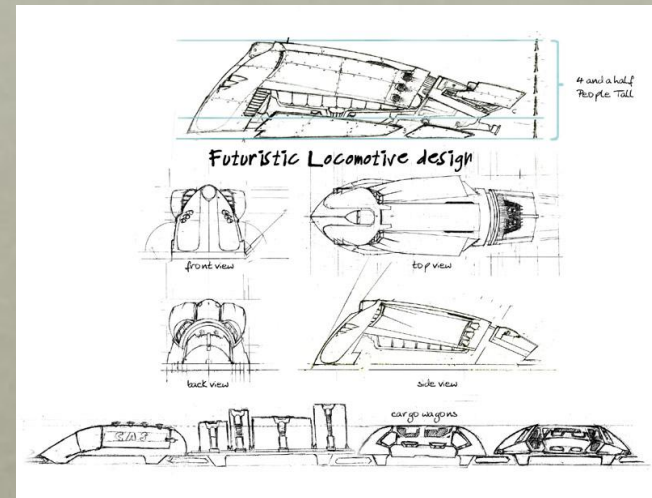

IF YOU HAVE ANY QUESTIONS...

- A Ridge High School Business or
Technology Education Teacher
 - Guidance Counselor
- Department Supervisor
 - Mr. Michael Fackelman
mfackelman@bernardsboe.com
908-204-2585, ext. 163